



TOMCAT TRAFFIC IMPACT BOLLARDS



FEATURES

- Engineered to meet ASTM F2656-SC40 and F3016-S30 guidelines
- One prefabricated bollard unit allows for quick installation and field adjustments
- No rebar required in the foundation
- Easily installed along curves and grade elevation changes
- Bollard spacing up to 54" on center minimizes quantity needed, reducing material and installation costs
- Removable bollard option available
- Available with a variety of cover options including stainless steel, thermoplastic, decorative shapes, concrete, lighted, and more

PRODUCT DETAILS

- Model #: TIB-67-SA
- Diameter: 6 5/8" Steel Pipe
- Foundation Depth: 30"
- Above Grade Height: 36"



Scan for more information.

TOMCAT TRAFFIC IMPACT BOLLARDS

TYPICAL SINGLE BOLLARD INSTALLATION

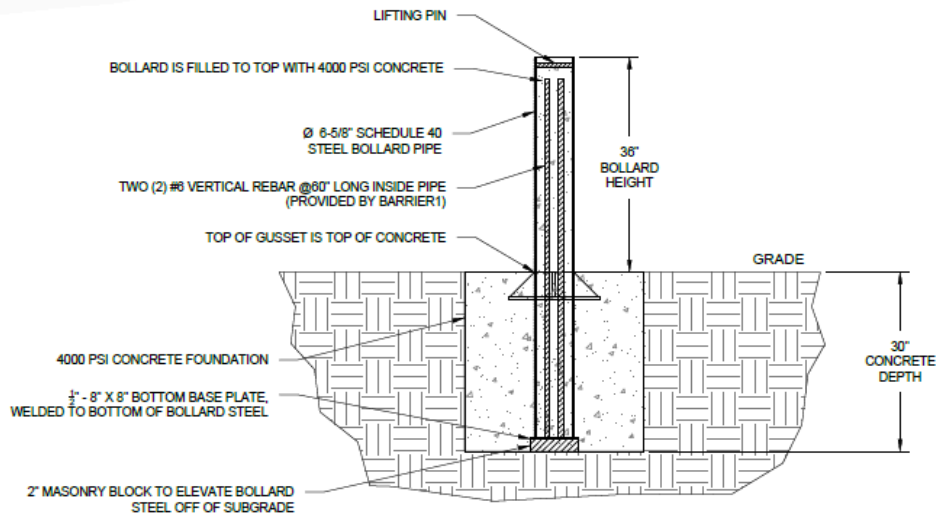

WHY BARRIER 1?

Core Competencies:

Barrier1 designs and manufactures crash-rated vehicle barriers that protect people, property, and critical infrastructure. Our solutions are engineered to stop vehicle-based threats while maintaining site functionality. Trusted across airports, military bases, stadiums, government buildings, data centers, and power plants, Barrier1 delivers proven perimeter protection.

What We Offer:

- Certified anti-ram barriers (ASTM F2656 & F3016)
- Shallow- and deep-mount options
- Temporary, removable, and permanent solutions
- Custom engineering and manufacturing
- Decorative covers and finishes for visual integration



MADE IN THE USA
Summerfield, NC