

TALON M40 SUPER SHALLOW MOUNT BOLLARDS



FEATURES

- Certified to stop a 15,000 lb vehicle at 40 mph (ASTM F2656-M40-P1)
- Ideal for sites requiring high-security bollards with limited foundation depth
- Industry-leading 4" foundation installs easily within existing city sidewalks
- A 3-bollard array installation is necessary to meet the crash-rating requirements
- Perfect for airport terminals, parking decks, subways, tunnels, city streets, and other shallow-foundation locations
- No tying, bolting, welding, assembly, or specialty subgrade required; allows for field adjustment

PRODUCT DETAILS

- Model #: SSB-800
- Bollard Size: 12"x12" Square Steel Tube
- Weight: 1,600 lbs. each (with rebar)
- Foundation Depth: 4"



Scan for more
information.

TALON M40 SUPER SHALLOW MOUNT BOLLARDS

TYPICAL BOLLARD ARRAY INSTALLATION

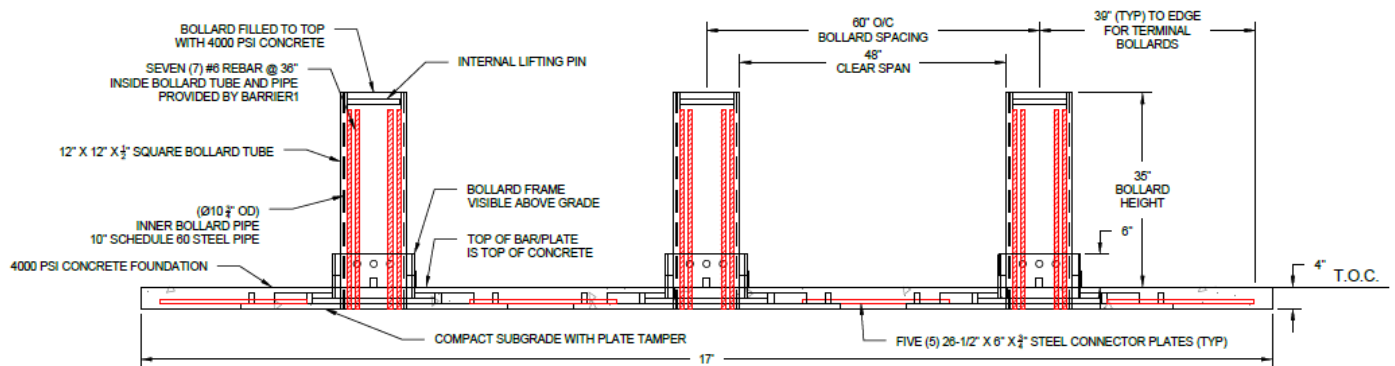

WHY BARRIER 1?

Core Competencies:

Barrier1 designs and manufactures crash-rated vehicle barriers that protect people, property, and critical infrastructure. Our solutions are engineered to stop vehicle-based threats while maintaining site functionality. Trusted across airports, military bases, stadiums, government buildings, data centers, and power plants, Barrier1 delivers proven perimeter protection.

What We Offer:

- Certified anti-ram barriers (ASTM F2656 & F3016)
- Shallow- and deep-mount options
- Temporary, removable, and permanent solutions
- Custom engineering and manufacturing
- Decorative covers and finishes for visual integration



MADE IN THE USA
Summerfield, NC