

# B1 TOMAHAWK M30

SHALLOW MOUNT BOLLARD - MODEL SMB-400-SSA

CRASH TESTED TO ASTM F2656-15 - M30/P1 RATED - STOPS 15,000 LB. VEHICLE AT 30 MPH IMPACT

## TYPICAL SINGLE BOLLARD INSTALLATION

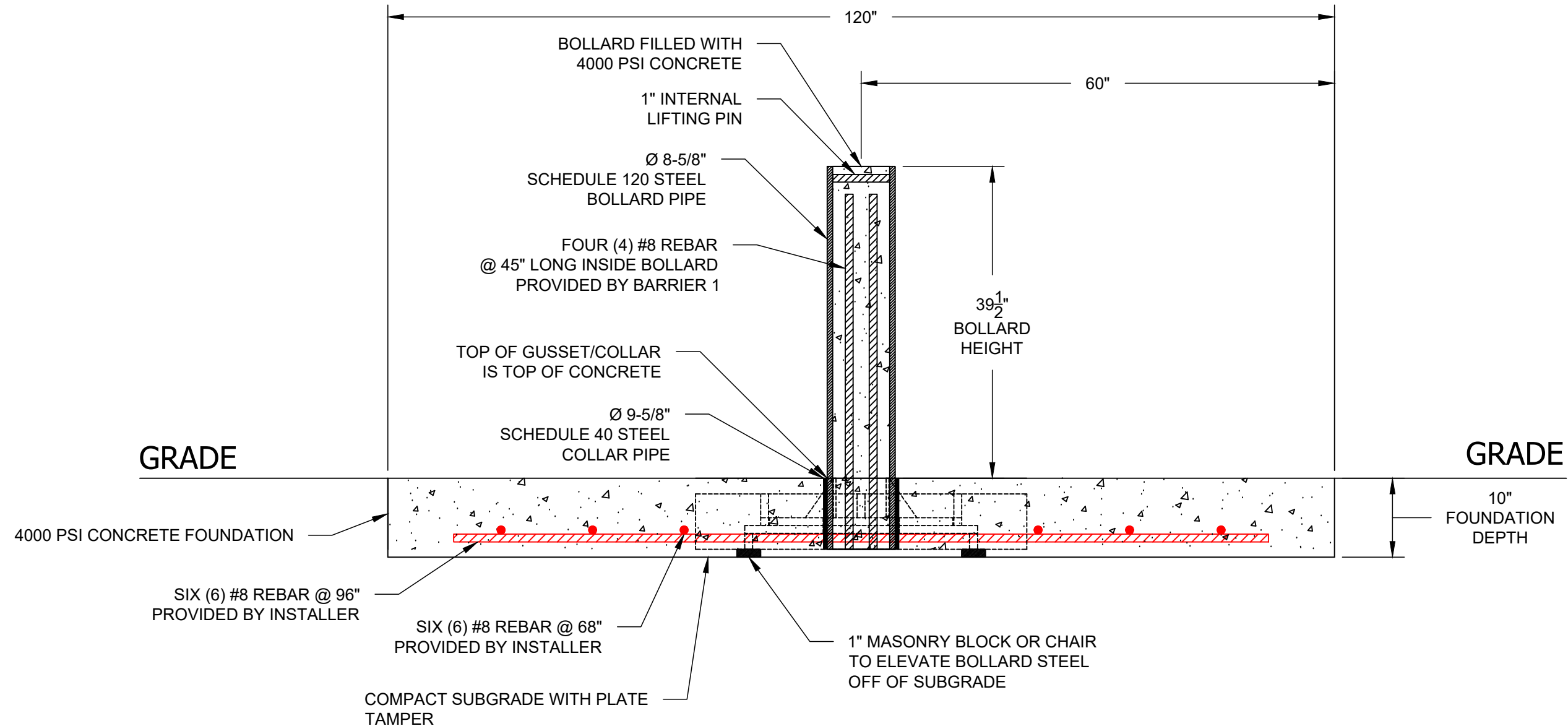

**BARRIER1 SYSTEMS, LLC**

5335 US HWY 220  
SUMMERFIELD, NC 27358  
(336) 617-8478 www.barrier1.com  
sales@barrier1.com

**PATENT PROTECTED**

**THE DRAWINGS AND INFORMATION CONTAINED HEREIN ARE PROPRIETARY AND CONFIDENTIAL, AND ARE AUTHORIZED ONLY FOR USE FOR WORK ASSOCIATED WITH BARRIER1 SYSTEMS, LLC ALL RIGHTS RESERVED.**

ELEVATION VIEW  
(STAND-ALONE)

SMB-400-SA  
WEBSITE DRAWING

SHEET: 1 OF 6

20250328-10-M

SCALE: N.T.S.

# B1 TOMAHAWK M30

SHALLOW MOUNT BOLLARD - MODEL SMB-400-SSA

CRASH TESTED TO ASTM F2656-15 - M30/P1 RATED - STOPS 15,000 LB. VEHICLE AT 30 MPH IMPACT

## TYPICAL SINGLE BOLLARD INSTALLATION

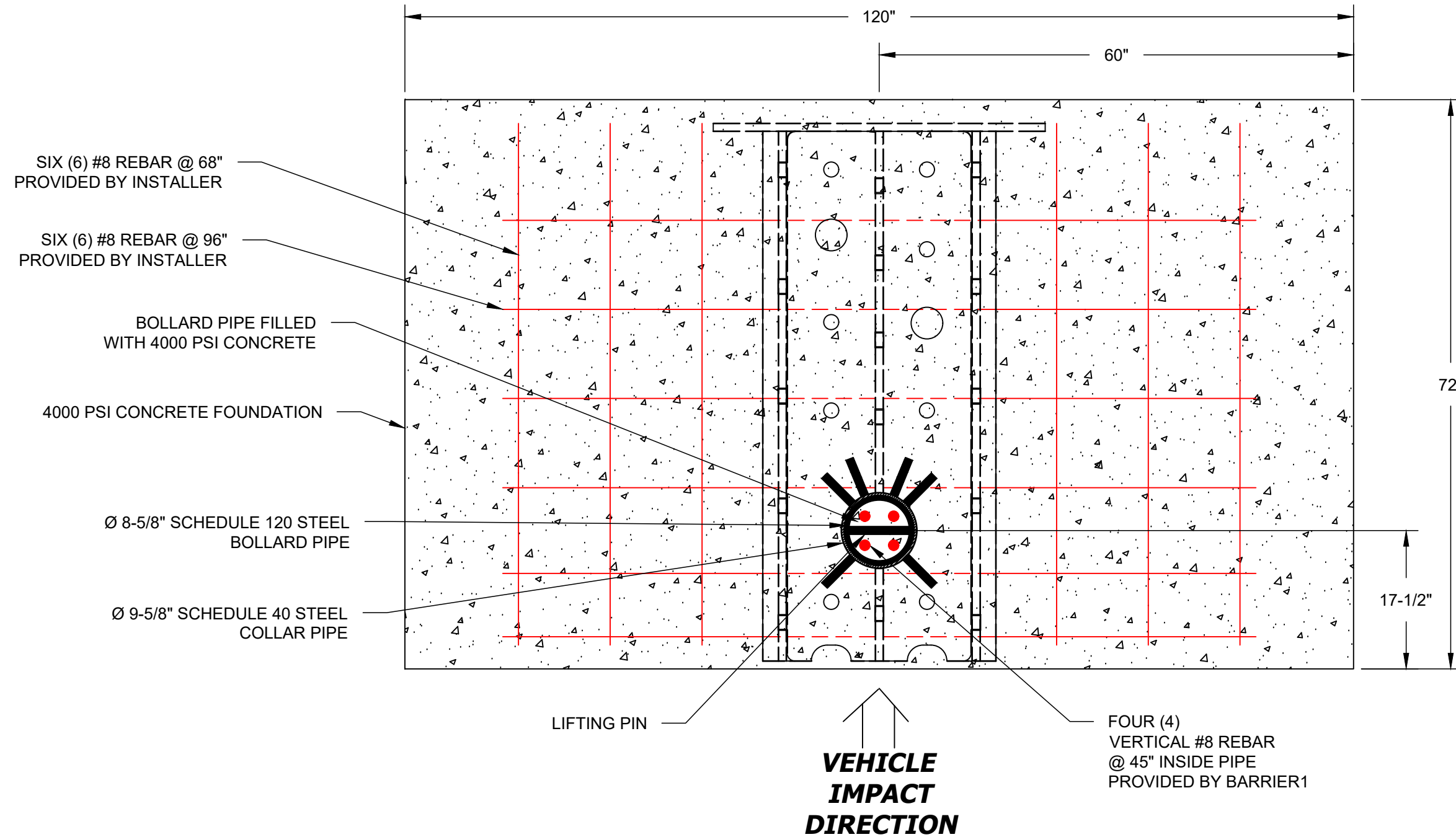

**BARRIER1 SYSTEMS, LLC**

5335 US HWY 220  
SUMMERFIELD, NC 27358  
(336) 617-8478 www.barrier1.com  
sales@barrier1.com

**PATENT PROTECTED**

**THE DRAWINGS AND INFORMATION CONTAINED HEREIN ARE  
PROPRIETARY AND CONFIDENTIAL, AND ARE AUTHORIZED ONLY  
FOR USE FOR WORK ASSOCIATED WITH BARRIER1 SYSTEMS, LLC  
ALL RIGHTS RESERVED.**

ELEVATION VIEW  
(STAND-ALONE)

SMB-400-SA  
WEBSITE DRAWING

SHEET: 2 OF 6

20250328-10-M

SCALE: N.T.S.

# B1 TOMAHAWK M30

SHALLOW MOUNT BOLLARD - MODEL SMB-400-SSA

CRASH TESTED TO ASTM F2656-15 - M30/P1 RATED - STOPS 15,000 LB. VEHICLE AT 30 MPH IMPACT

## TYPICAL BOLLARD ARRAY INSTALLATION

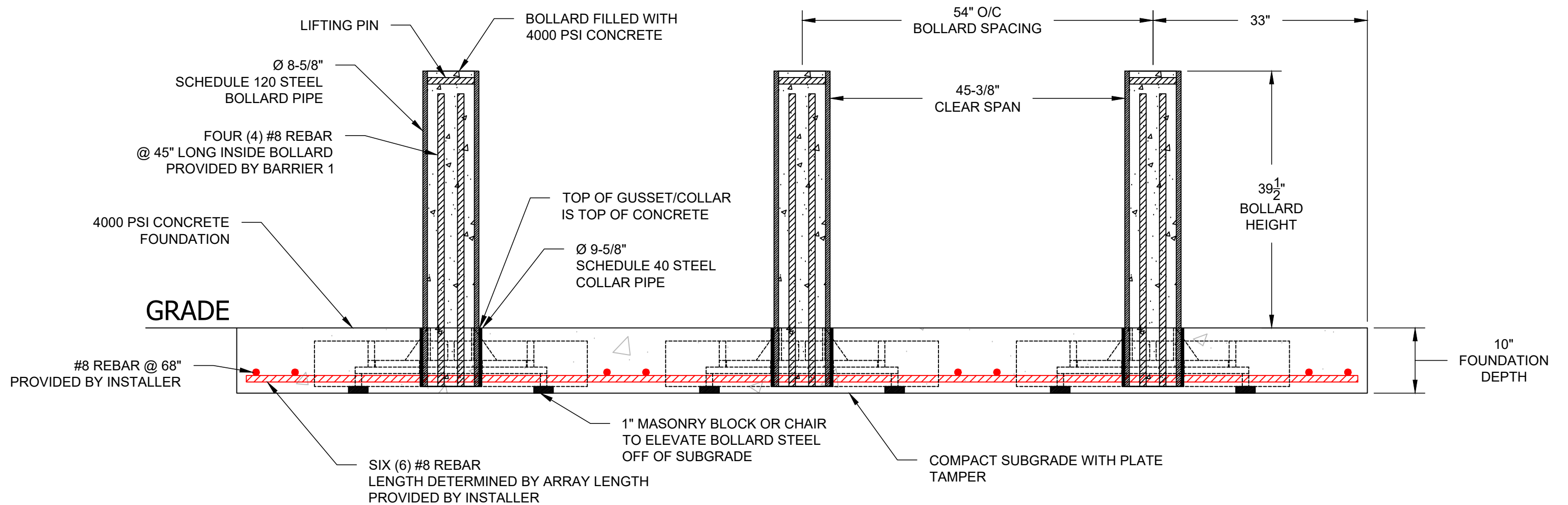

**NOTE:**

- 1. MODIFIED SPACING FOR SITE SPECIFIC CONDITIONS AVAILABLE



**BARRIER1 SYSTEMS, LLC**

5335 US HWY 220  
SUMMERFIELD, NC 27358  
(336) 617-8478 www.barrier1.com  
sales@barrier1.com

**PATENT PROTECTED**

**THE DRAWINGS AND INFORMATION CONTAINED HEREIN ARE PROPRIETARY AND CONFIDENTIAL, AND ARE AUTHORIZED ONLY FOR USE FOR WORK ASSOCIATED WITH BARRIER1 SYSTEMS, LLC ALL RIGHTS RESERVED.**

ELEVATION VIEW  
(ARRAY - MODIFIED)

SMB-400-SA  
WEBSITE DRAWING

SHEET: 3 OF 6

20250328-10-M

SCALE: N.T.S.

# B1 TOMAHAWK M30

SHALLOW MOUNT BOLLARD - MODEL SMB-400-SSA

CRASH TESTED TO ASTM F2656-15 - M30/P1 RATED - STOPS 15,000 LB. VEHICLE AT 30 MPH IMPACT

## TYPICAL BOLLARD ARRAY INSTALLATION

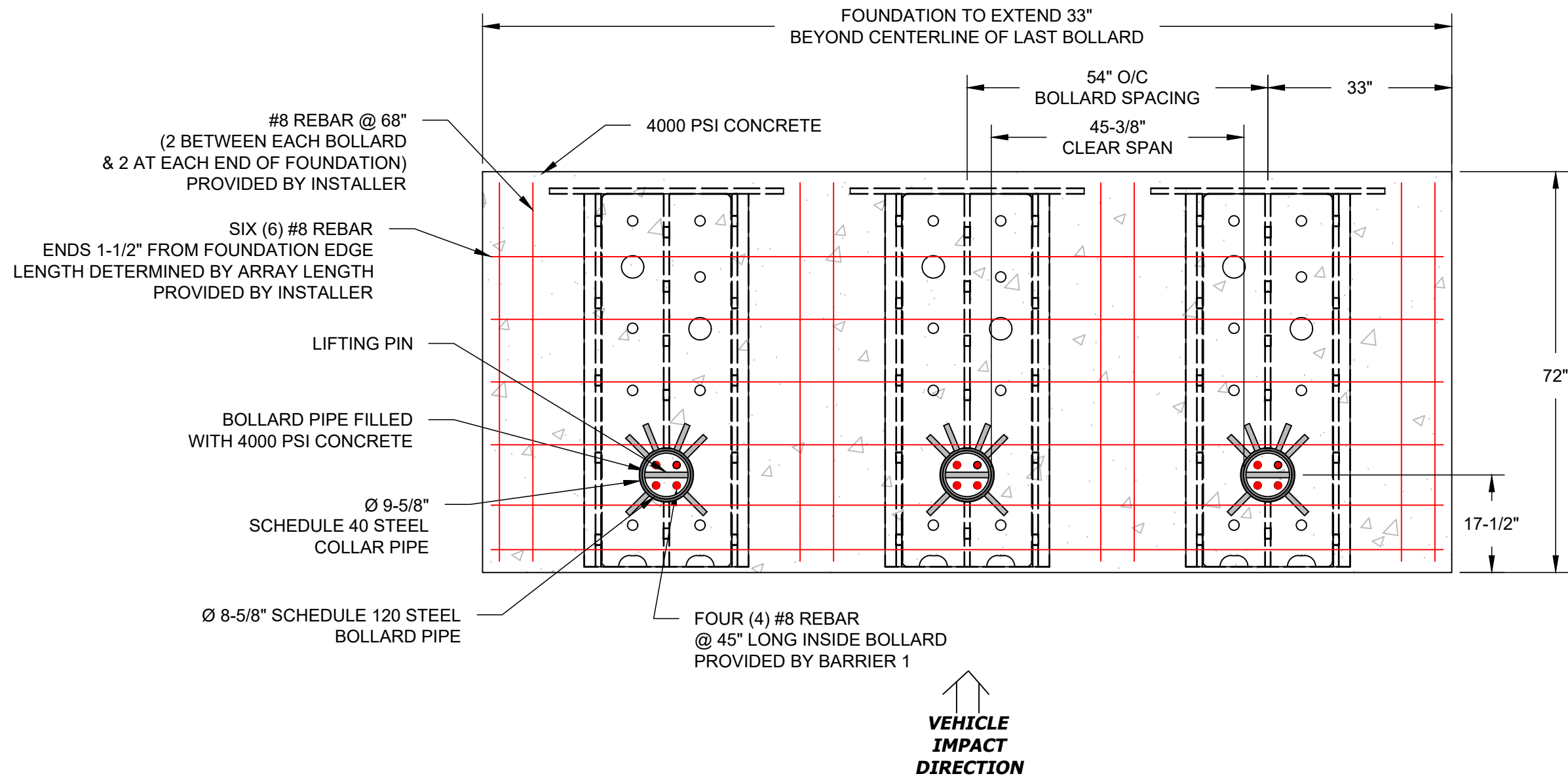

**NOTE:**

1. MODIFIED SPACING FOR SITE SPECIFIC CONDITIONS AVAILABLE



**BARRIER1 SYSTEMS, LLC**

5335 US HWY 220  
SUMMERFIELD, NC 27358  
(336) 617-8478 www.barrier1.com  
sales@barrier1.com

**PATENT PROTECTED**

**THE DRAWINGS AND INFORMATION CONTAINED HEREIN ARE PROPRIETARY AND CONFIDENTIAL, AND ARE AUTHORIZED ONLY FOR USE FOR WORK ASSOCIATED WITH BARRIER1 SYSTEMS, LLC ALL RIGHTS RESERVED.**

PLAN VIEW  
(ARRAY)

SMB-400-SA  
WEBSITE DRAWING

SHEET: 4 OF 6

20250328-10-M

SCALE: N.T.S.

# B1 TOMAHAWK M30

SHALLOW MOUNT BOLLARD - MODEL SMB-400-SSA

CRASH TESTED TO ASTM F2656-15 - M30/P1 RATED - STOPS 15,000 LB. VEHICLE AT 30 MPH IMPACT

## MATERIALS PROVIDED

### MATERIALS PROVIDED BY BARRIER1 SYSTEMS

STANDARD FINISH:  
GLOSS BLACK PAINT

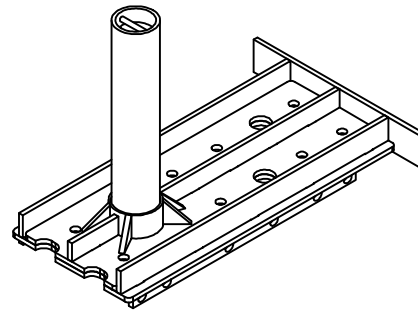

(1) EACH:  
PREFABRICATED BOLLARD

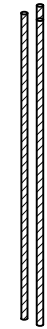

(4) EACH:  
#8 VERTICAL REBAR  
@ 45"

### MATERIALS PROVIDED BY INSTALLER:

1. ABOUT 1.0 CUBIC YARDS OF CONCRETE PER BOLLARD FOR ARRAY  
ABOUT 2.0 CUBIC YARDS OF CONCRETE PER BOLLARD FOR STANDALONE
2. SIX (6) #8 HORIZONTAL REBAR @96" PER BOLLARD OR BY ARRAY LENGTH TO  
CONNECT ADJACENT BOLLARDS
3. #8 HORIZONTAL REBAR @68" LAID OVER #8 @ 96" REBAR BETWEEN ADJACENT  
BOLLARDS AND EDGE OF FOUNDATION
4. MASONRY BRICKS OR CHAIRS TO ELEVATE BOLLARD STEEL OFF SUBGRADE



**BARRIER1 SYSTEMS, LLC**

5335 US HWY 220  
SUMMERFIELD, NC 27358  
(336) 617-8478 www.barrier1.com  
sales@barrier1.com

**PATENT PROTECTED**

**THE DRAWINGS AND INFORMATION CONTAINED HEREIN ARE  
PROPRIETARY AND CONFIDENTIAL, AND ARE AUTHORIZED ONLY  
FOR USE FOR WORK ASSOCIATED WITH BARRIER1 SYSTEMS, LLC  
ALL RIGHTS RESERVED.**

MATERIALS  
PROVIDED

SMB-400-SA  
WEBSITE DRAWING

SHEET: 5 OF 6

20250328-10-M

SCALE: N.T.S.



# B1 TOMAHAWK M30

SHALLOW MOUNT BOLLARD - MODEL SMB-400-SSA

CRASH TESTED TO ASTM F2656-15 - M30/P1 RATED - STOPS 15,000 LB. VEHICLE AT 30 MPH IMPACT

## INSTALLATION STEPS

① EXCAVATE THEN TAMP SUBGRADE WITH PLATE TAMPER.

② USE MASONRY BLOCK OR CHAIRS TO ELEVATE BOLLARD OFF SUBGRADE, SO THAT TOP OF GUSSET / SLEEVE IS SAME HEIGHT AS TOP OF CONCRETE.

③ PLACE PREFABRICATED BOLLARDS INTO EXCAVATION.

④ INSERT VERTICAL REBAR INTO BOLLARD TUBE.

⑤ INSERT #8 REBAR THROUGH PREFABRICATED HOLES TO CONNECT BOLLARDS.

⑥ POUR AND VIBRATE CONCRETE IN BOLLARD TUBE AND EXCAVATION

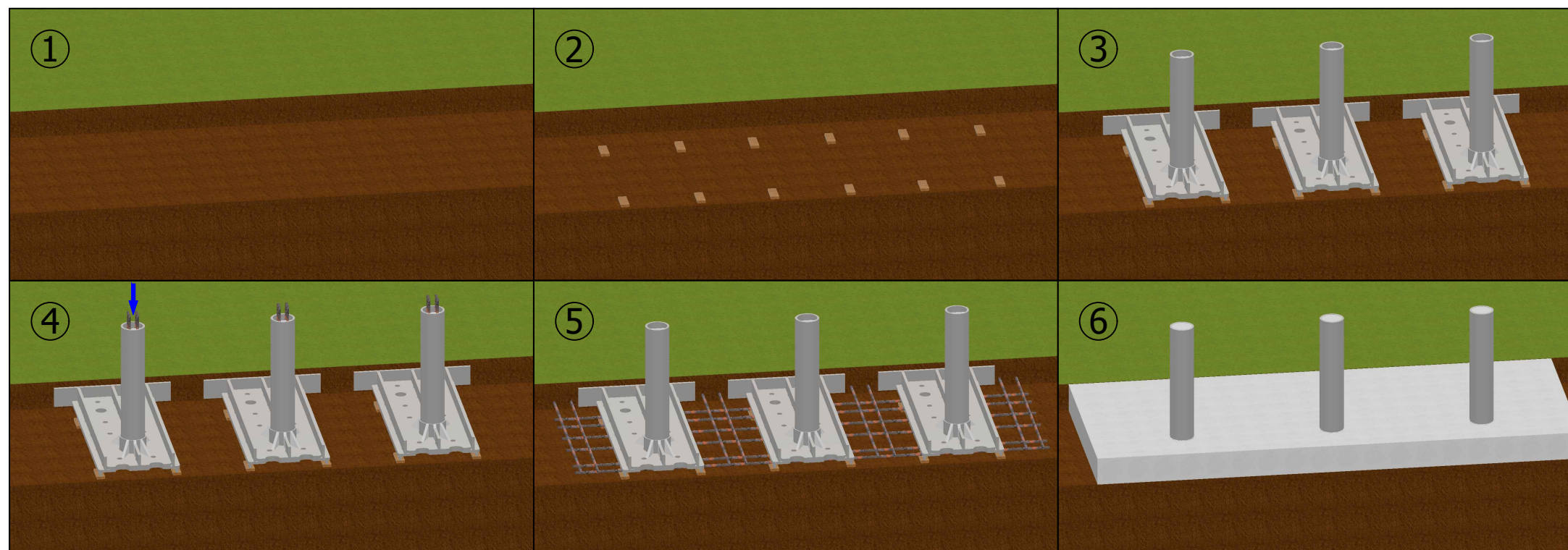

**BARRIER1 SYSTEMS, LLC**

5335 US HWY 220  
SUMMERFIELD, NC 27358  
(336) 617-8478 www.barrier1.com  
sales@barrier1.com

**PATENT PROTECTED**

**THE DRAWINGS AND INFORMATION CONTAINED HEREIN ARE PROPRIETARY AND CONFIDENTIAL, AND ARE AUTHORIZED ONLY FOR USE FOR WORK ASSOCIATED WITH BARRIER1 SYSTEMS, LLC ALL RIGHTS RESERVED.**

INSTALLATION STEPS

SMB-400-SA  
WEBSITE DRAWING

SHEET: 6 OF 6

20250328-10-M

SCALE: N.T.S.