

# B1 TALON M40

SUPER SHALLOW POST - MODEL SSP-800

CRASH TESTED TO ASTM F2656-07 - M40/P1 RATED - STOPS 15,000 LB. VEHICLE AT 40 MPH IMPACT

## TYPICAL BOLLARD ARRAY INSTALLATION

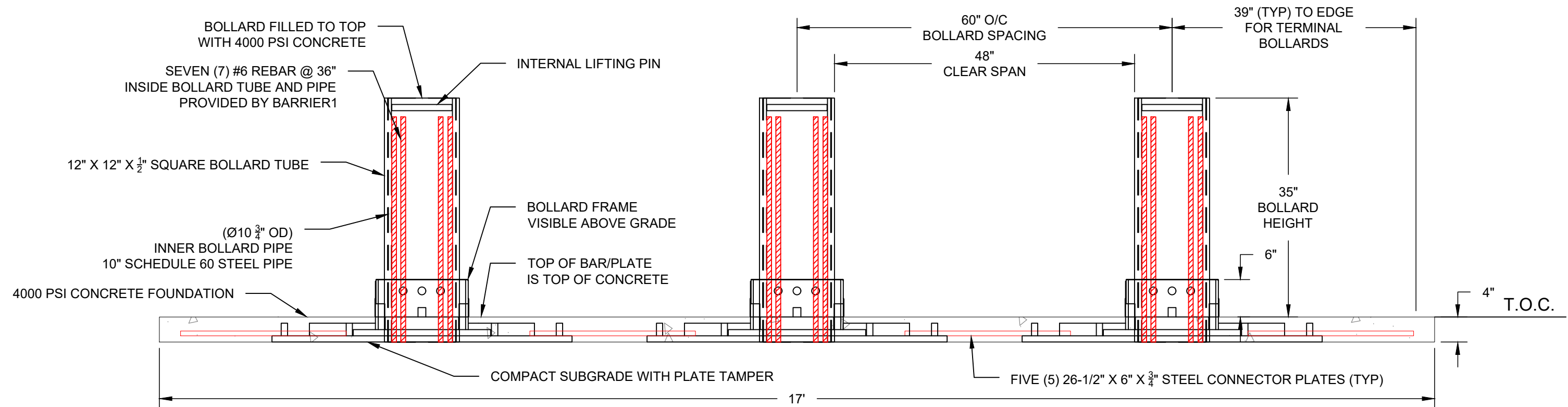

NOTE:  
MODIFIED SPACING FOR SITE SPECIFIC CONDITIONS AVAILABLE.



**BARRIER1 SYSTEMS, LLC**

5335 US HWY 220  
SUMMERFIELD, NC 27358  
(336) 617-8478 www.barrier1.com  
sales@barrier1.com

**PATENT PROTECTED**

**THE DRAWINGS AND INFORMATION CONTAINED HEREIN ARE PROPRIETARY AND CONFIDENTIAL, AND ARE AUTHORIZED ONLY FOR USE FOR WORK ASSOCIATED WITH BARRIER1 SYSTEMS, LLC ALL RIGHTS RESERVED.**

ELEVATION VIEW

SSP-800  
WEBSITE DRAWING

SHEET: 1 OF 4

20250212-10-S

SCALE: N.T.S.

# B1 TALON M40

SUPER SHALLOW POST - MODEL SSP-800

CRASH TESTED TO ASTM F2656-07 - M40/P1 RATED - STOPS 15,000 LB. VEHICLE AT 40 MPH IMPACT

## TYPICAL BOLLARD ARRAY INSTALLATION

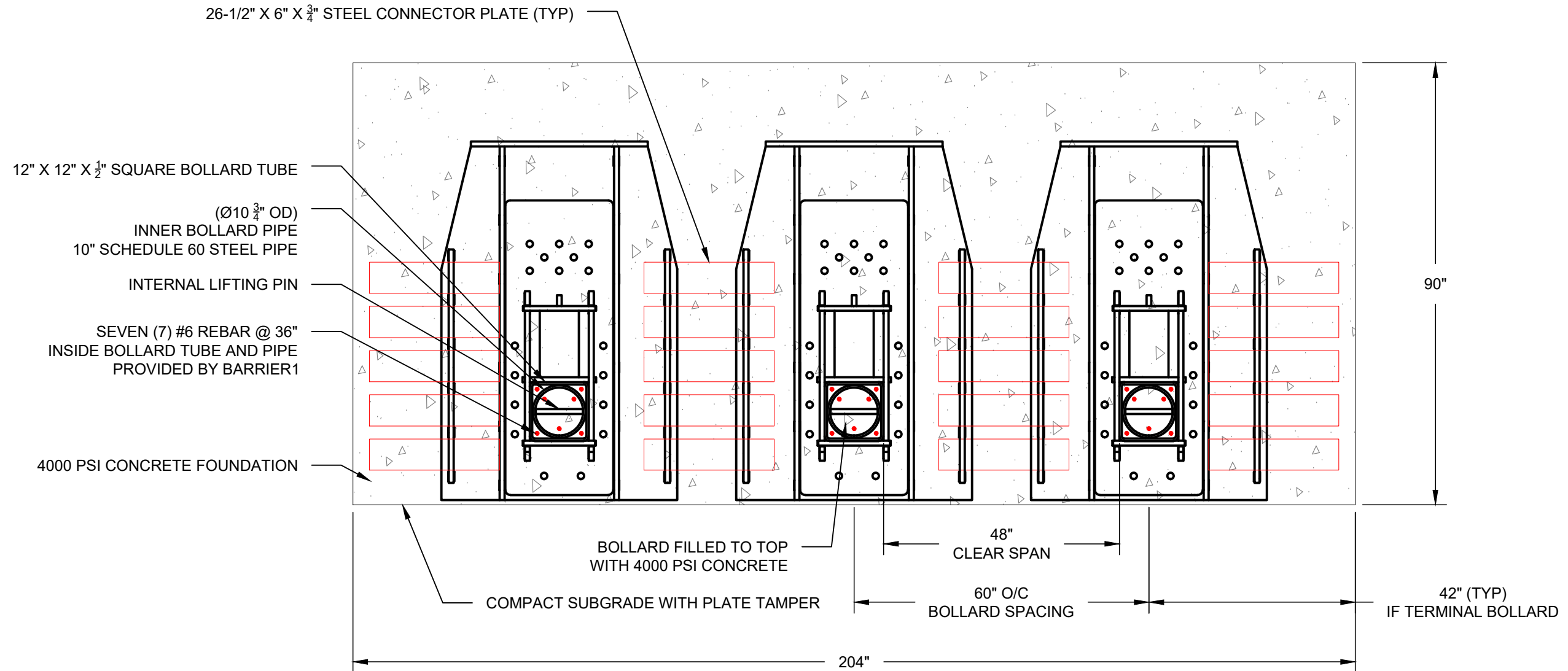

NOTE:  
MODIFIED SPACING FOR SITE SPECIFIC CONDITIONS AVAILABLE.



**BARRIER1 SYSTEMS, LLC**

5335 US HWY 220  
SUMMERFIELD, NC 27358  
(336) 617-8478 www.barrier1.com  
sales@barrier1.com

**PATENT PROTECTED**

**THE DRAWINGS AND INFORMATION CONTAINED HEREIN ARE  
PROPRIETARY AND CONFIDENTIAL, AND ARE AUTHORIZED ONLY  
FOR USE FOR WORK ASSOCIATED WITH BARRIER1 SYSTEMS, LLC  
ALL RIGHTS RESERVED.**

PLAN VIEW

SSP-800  
WEBSITE DRAWING

SHEET: 2 OF 4

20250212-10-S

SCALE: N.T.S.

# B1 TALON M40

SUPER SHALLOW POST - MODEL SSP-800

CRASH TESTED TO ASTM F2656-07 - M40/P1 RATED - STOPS 15,000 LB. VEHICLE AT 40 MPH IMPACT

## MATERIALS PROVIDED

### MATERIALS PROVIDED BY BARRIER1 SYSTEMS

STANDARD FINISH:  
BLACK PAINT

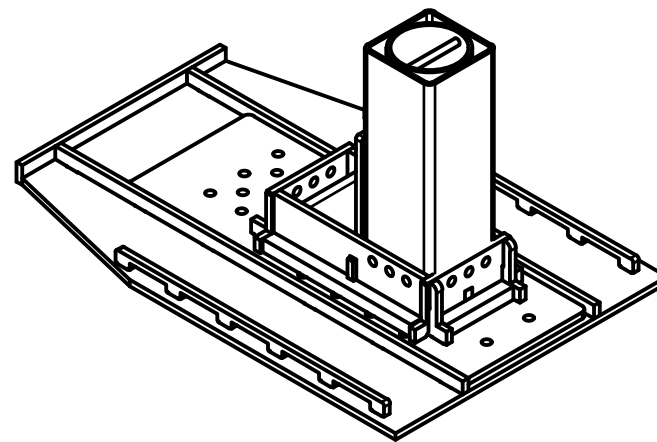

(QTY: 1) EACH:  
PREFABRICATED BOLLARD  
WITH BASE STRUCTURE  
(PRE-ASSEMBLED)

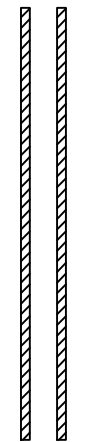

(QTY: 7) EACH:  
PRECUT #6 REBAR @ 36" LONG  
PLACED INSIDE BOLLARD TUBE (4) AND INNER  
BOLLARD PIPE (3)

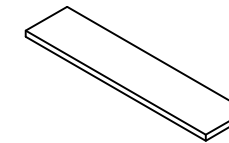

(QTY: 7) EACH:  
CONNECTOR PLATE

### MATERIALS PROVIDED BY INSTALLATION CONTRACTOR:

1. ABOUT 1.0 CUBIC YARDS OF CONCRETE PER BOLLARD
2. SIX (6) #5 HORIZONTAL REBAR PER BOLLARD TO CONNECT ADJACENT BOLLARDS
3. MASONRY BRICKS OR CHAIRS TO ELEVATE BOLLARD STEEL OFF SUBGRADE



**BARRIER1 SYSTEMS, LLC**

5335 US HWY 220  
SUMMERFIELD, NC 27358  
(336) 617-8478 www.barrier1.com  
sales@barrier1.com

**PATENT PROTECTED**

**THE DRAWINGS AND INFORMATION CONTAINED HEREIN ARE  
PROPRIETARY AND CONFIDENTIAL, AND ARE AUTHORIZED ONLY  
FOR USE FOR WORK ASSOCIATED WITH BARRIER1 SYSTEMS, LLC  
ALL RIGHTS RESERVED.**

MATERIALS  
PROVIDED

SSP-800  
WEBSITE DRAWING

SHEET: 3 OF 4

20250212-10-S

SCALE: N.T.S.

# B1 TALON M40

SUPER SHALLOW POST - MODEL SSP-800

CRASH TESTED TO ASTM F2656-07 - M40/P1 RATED - STOPS 15,000 LB. VEHICLE AT 40 MPH IMPACT

## INSTALLATION STEPS

① EXCAVATE THEN TAMP SUBGRADE WITH PLATE TAMPER.

② PLACE PREFABRICATED BOLLARDS INTO EXCAVATION.

③ INSERT CONNECTION PLATES INSIDE PREFABRICATED SLOTS TO CONNECT BOLLARDS.

④ FILL BOLLARD TUBE AND FOUNDATION WITH CONCRETE.

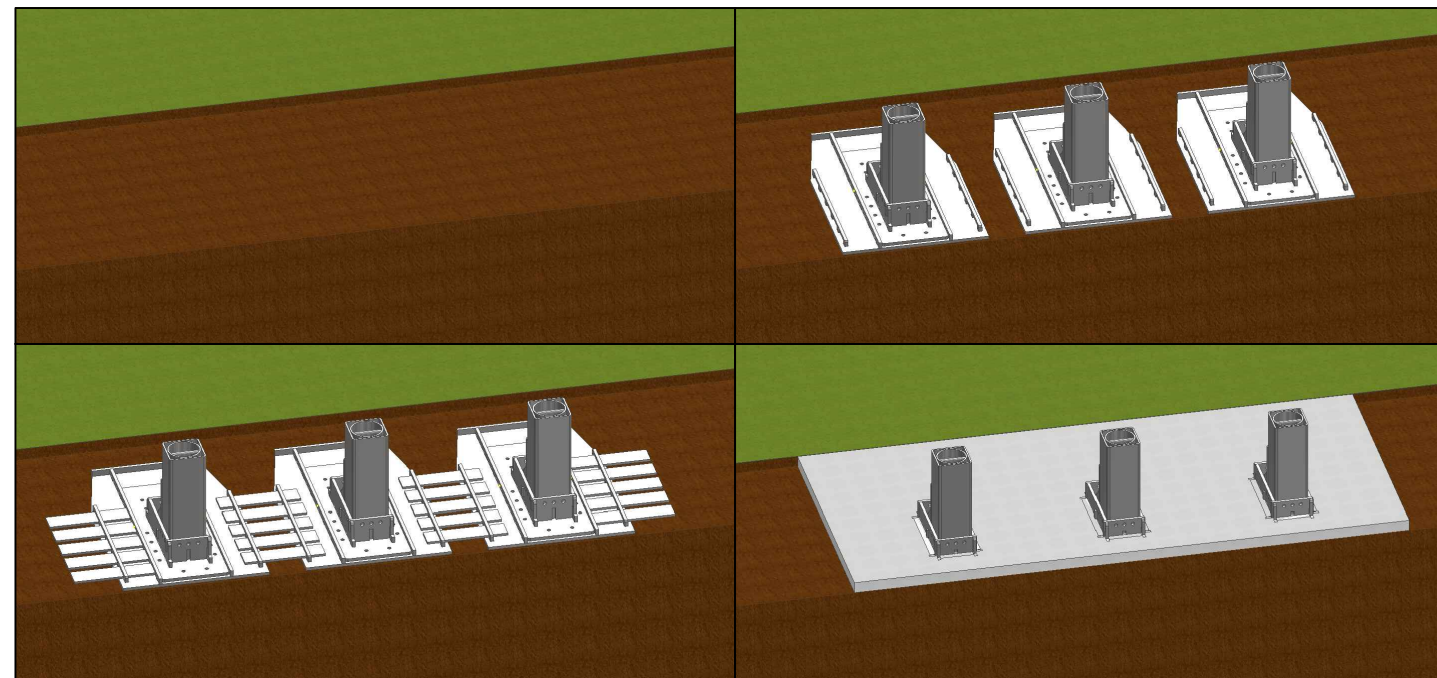

**BARRIER1 SYSTEMS, LLC**

5335 US HWY 220  
SUMMERFIELD, NC 27358  
(336) 617-8478 www.barrier1.com  
sales@barrier1.com

**PATENT PROTECTED**

**THE DRAWINGS AND INFORMATION CONTAINED HEREIN ARE PROPRIETARY AND CONFIDENTIAL, AND ARE AUTHORIZED ONLY FOR USE FOR WORK ASSOCIATED WITH BARRIER1 SYSTEMS, LLC ALL RIGHTS RESERVED.**

INSTALLATION STEPS

SSP-800  
WEBSITE DRAWING

SHEET: 4 OF 4

20250212-10-S

SCALE: N.T.S.